



House on one level

CUVRY (57)

**619 000 €\***

\* Agency fees to be paid by the seller



168 m<sup>2</sup>



6 pièce(s)



3 chambre(s)

## PROPERTY DESCRIPTION

Close to Marly, in Cuvry, sought after village, High-end Individual Architectural Villa, T6 single storey, Clos des Bois Précieux, 168m<sup>2</sup>, large garage for 2 vehicles, 4 private parking spaces, Piscinable land. Land of 672m<sup>2</sup> Virtual visit on demand Looking for great services, in a beautiful green environment, then drop off your suitcases. I present to you, the house you have always dreamed of !! On the space side, a beautiful entrance opening onto a living room opening onto the kitchen of nearly 67m<sup>2</sup>, leading to its large terrace and patio, the bedrooms, a bathroom as well as a large master suite and its bathroom. You will also find a beautiful mezzanine overlooking a panoramic terrace. You can make an office, bedroom, games / sports room, ..... Indulge yourself !!! Comfort side: electric underfloor heating Finally, location side: Close to all amenities and highways The +: Close to the forest High-end services Terraces + Patio Single storey Do not delay too much !! Les honoraires sont à la charge du vendeur.

Les informations sur les risques auxquels ce bien est exposé sont disponibles sur le site Géorisques : [www.georisques.gouv.fr](http://www.georisques.gouv.fr).

**\*\* ENGLISH SPEAKERS:** please note that Capifrance has an international department that can help with translations. To see our range of 20,000 properties for sale in France, please visit our Capifrance website directly. We look forward to finding your dream home!



**Robert CIPOLLA**

**HAGONDANGE (57300)**

Agent

RSAC : 828 461 566 00014

Courts service city : METZ

**(+33)6 73 28 60 86**

## LE BIEN EN IMAGES

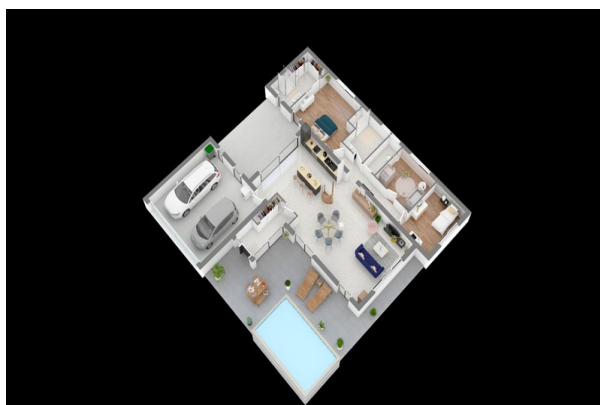

## DETAILS

### GENERAL

Reference ..... 840530

Property type ..... House on one level

Exposure ..... S-W

View ..... Vue dégagée, sur Forêt, sur Jardin

### SURFACES

Living space ..... 168 m²

Living room surface ..... 45 m²

Land surface ..... 672 m²

### COMPOSITION

Number of rooms ..... 6

Number of bedrooms ..... 3

Number of bathrooms ..... 2

Toilets count ..... 2

Terrace ..... 1

### APPENDIX

Parking ..... couvert

Parking space ..... 4

Garage ..... 1

Videophone ..... Non

### SERVICES

Heater ..... électricité

Swimming-pool ..... Yes



CAPIFRANCE  
639 rue du Mas de Verchant, Immeuble Diver'city - 34 170 Castelnau Le Lez  
CS 70058 34 473 Pérols Cedex  
RCS de Montpellier n° 441 338 985  
SAS au capital de 100.000 euros

Ces éléments sont donnés à titre indicatif et de bonne foi et n'ont aucune valeur contractuelle